

# Belts

CE restraint belts feature side attachment points for a support lanyard and are equipped with three tool bag buckles. The size is easily and quickly adjusted by a single set of loops. The belt is held in place with plastic loops. They can be combined with any harness from our range, using belt loops, making a fully integrated belt-harness solution.



## Safety Belt CE06

### EN358

- Two wide easy access forged steel fastening buckles of 60mm.
- Large comfortable foam backpad.

Model	Size (Apparel)	Product Code
Safety Belt CE06 - Standard Buckles	S	80242
Safety Belt CE06 - Standard Buckles	M	80252
Safety Belt CE06 - Standard Buckles	XL	80262
Safety Belt CE06 - Quick-release buckles - Size S	S	80272
Safety Belt CE06 - Quick-release buckles - Size M	M	80282
Safety Belt CE06 - Quick-release buckles - Size XL	XL	80292





## Safety Belt CE01

### EN358

- Belt fits all harnesses with 2 pressed D ring of 45mm.

Model	Size (Apparel)	Product Code
Safety Belt CE01 - Standard Buckles	S	32882
Safety Belt CE01 - Standard Buckles	M	10052
Safety Belt CE01 - Standard Buckles	XL	10062
Safety Belt CE01 - Quick-release buckles	S	33202
Safety Belt CE01 - Quick-release buckles	M	33212
Safety Belt CE01 - Quick-release buckles	XL	33222

 Order products on day 1, will be shipped no later than day 2,

 Order products on day 1, will be shipped no later than day 6. Maximum quantities apply for this service.

 Available on request. Please enquire about delivery times of these items.

# Accessories

## Rescue lanyard option R

Rescue lanyard with 3 connectors M10 to evacuate a casualty. This 60 cm long webbing extension fits all Tractel® harnesses.

It is fixed directly onto the shoulder straps of the harness via two M10 connectors.

The rescue system is fixed onto the other end using a connector.

Model	Product Code
Option R	83892

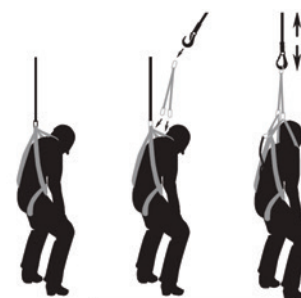

## Option RL

### EN354

45mm webbing anchorage extender that attaches to the back D-ring of a fall arrest harness. The extender is equipped with a plastic loop that allows the soft strand of the webbing to be positioned on one of the harness back straps when the extender is not in use.

#### Dimensions (mm)

- Webbing width 45 mm
- Total length: 260 mm
- 2 sewn loops
- Max. working load: 150 kg

#### Material

- Webbing: polyester

Model	Product Code
Option RL	32872

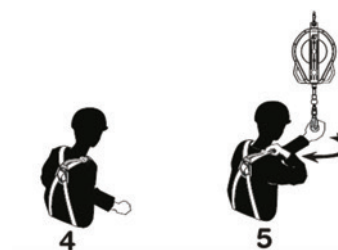
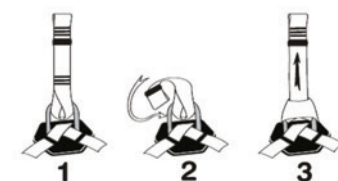

 Order products on day 1, will be shipped no later than day 2,

 Order products on day 1, will be shipped no later than day 6. Maximum quantities apply for this service.

 Available on request. Please enquire about delivery times of these items.